

Spare parts list
auma[®]
 Multi-turn actuators
 SA 07.1 – SA 16.1
 SAR 07.1 – SAR 16.1
 AUMA NORM

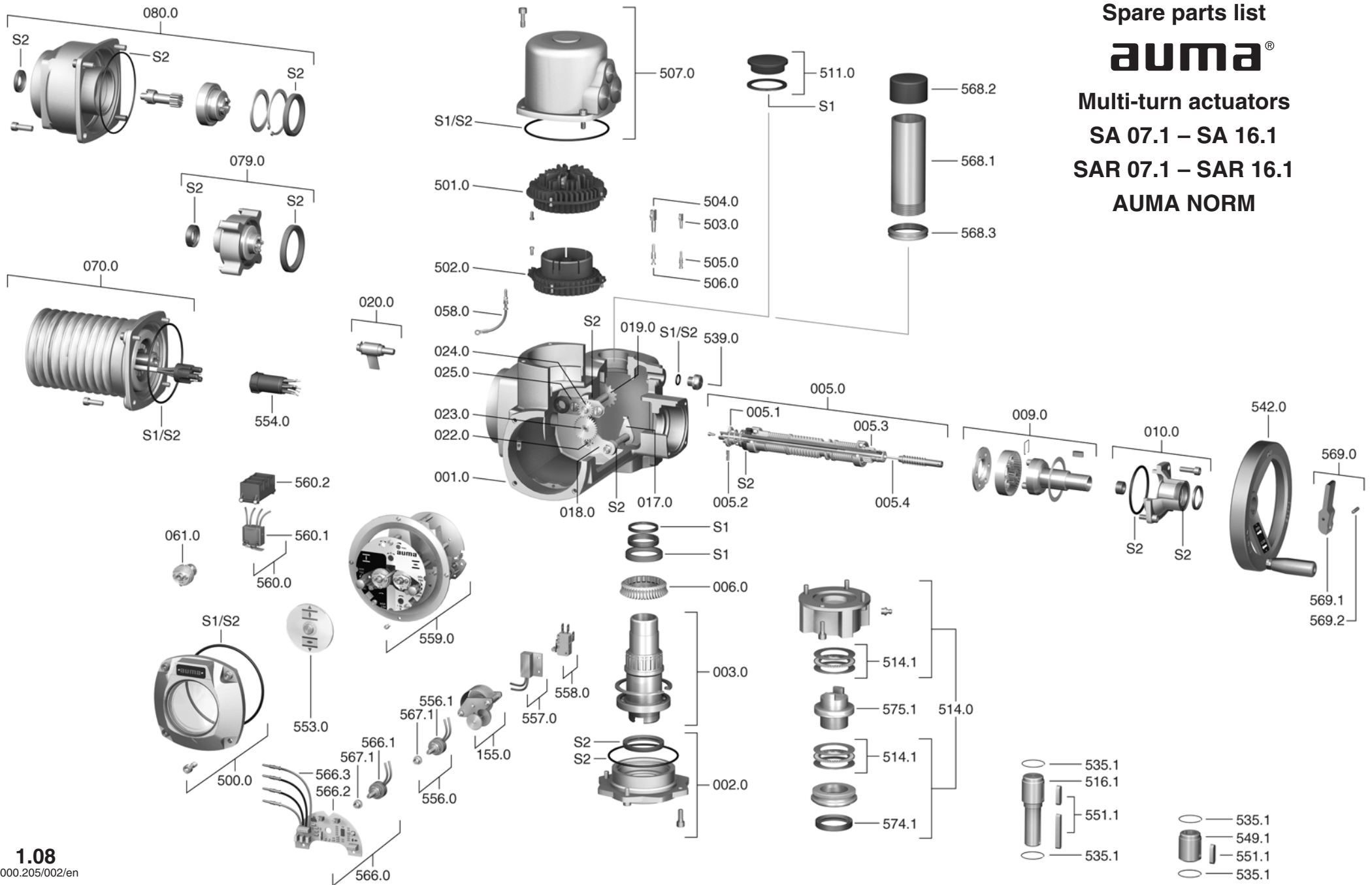

Please state type and commission no. of the device (see name plate) when ordering spare parts. Only original AUMA spare parts should be used. Failure to use original spare parts voids the warranty and exempts AUMA from any liability. Delivered spare parts may slightly vary from the representation.

No.	Designation	Type	No.	Designation	Type
001.0	Housing	Sub-assembly	559.0-1	Control unit without torque switching heads and switches	Sub-assembly
002.0	Bearing flange	Sub-assembly			
003.0	Hollow shaft without worm wheel	Sub-assembly	559.0-2	Control unit with magnetic limit and torque transmitter (MWG) for Non-intrusive version in combination with AUMATIC integral controls	Sub-assembly
005.0	Worm shaft	Sub-assembly			
005.1	Motor coupling				
005.2	Coupling pin				
005.3	Manual drive coupling		560.0-1	Switch stack for direction OPEN	Sub-assembly
005.4	Pull rope		560.0-2	Switch stack for direction CLOSE	Sub-assembly
006.0	Worm wheel		560.1	Switch for limit/torque switching	
009.0	Planetary gear for manual drive	Sub-assembly	560.2	Switch case	
010.0	Retaining flange	Sub-assembly	566.0	Position transmitter RWG	Sub-assembly
017.0	Torque lever	Sub-assembly	566.1	Potentiometer for RWG without slip clutch	Sub-assembly
018.0	Gear segment		566.2	Electronic board RWG	Sub-assembly
019.0	Crown wheel	Sub-assembly	566.3	Wire harness for RWG	Sub-assembly
020.0	Swing lever	Sub-assembly	567.1	Slip clutch for potentiometer/RWG	Sub-assembly
022.0	Drive pinion II for torque switching	Sub-assembly	568.1	Stem protection tube (without cap)	
023.0	Output drive wheel for limit switching	Sub-assembly	568.2	Cap for stem protection tube	
024.0	Intermediate wheel for limit switching	Sub-assembly	568.3	V-seal	
025.0	Locking plate	Sub-assembly	569.0	Change-over lever assy	
058.0	Wire for protective earth (pin)	Sub-assembly	569.1	Change-over lever	
061.0	Torque switching head	Sub-assembly	569.2	Notched pin	
070.0	Motor (VD motor incl. no. 079.0)	Sub-assembly	574.1	Radial seal output drive A for ISO flange	
079.0	Planetary gear for motor drive (SA/SAR 07.1 – 14.1 for VD motor)	Sub-assembly	575.1	Stem nut type A	
			S1	Seal kit, small	Set
080.0	Planetary gear for motor drive (SA/SAR 16.1 for AD90 motor)	Sub-assembly	S2	Seal kit, large	Set
155.0	Reduction gearing	Sub-assembly			
500.0	Cover for switch compartment	Sub-assembly			
501.0	Socket carrier (complete with sockets)	Sub-assembly			
502.0	Pin carrier without pins	Sub-assembly			
503.0	Socket for controls	Sub-assembly			
504.0	Socket for motor	Sub-assembly			
505.0	Pin for controls	Sub-assembly			
506.0	Pin for motor	Sub-assembly			
507.0	Plug cover	Sub-assembly			
511.0	Screw plug	Sub-assembly			
514.0	Output drive form A (without stem nut)	Sub-assembly			
514.1	Axial needle roller bearing	Sub-assembly			
516.1	Output drive shaft D				
535.1	Snap ring				
539.0	Screw plug				
542.0	Handwheel with ball handle	Sub-assembly			
549.1	Output socket B3/B4/E				
551.1	Parallel key				
553.0	Mechanical position indicator	Sub-assembly			
554.0	Socket carrier with motor cable harness	Sub-assembly			
556.0	Potentiometer for position transmitter	Sub-assembly			
556.1	Potentiometer without slip clutch	Sub-assembly			
557.0	Heater	Sub-assembly			
558.0	Blinker transmitter including pins at wires (without impulse disc and insulation plate)	Sub-assembly			

We reserve the right to alter data according to improvements made. Previous documents become invalid with the issue of this document.